



**REBUILT LIKE NEW**

## Fuji ANW-4100R



**Built: 2004    Serial# 14466    Control: 180i-TB    12 Station Live Tool turrets  
Includes 10 Station workstocker**

**Price: \$ 215,000**

Specifications  
for ANW-3000  
4100

				ANW-3000 (R)	ANW-4100 (R)
Machine Specifications	Recommended work size	mm [inch]		φ200×100 [φ7.8"×3.93"]	φ300×120 [φ8"×4.7" ]
	Spindle dia.	mm [inch]		φ100 [φ3.94"]	φ120 [φ4.72"]
	Spindle bore dia.	mm [inch]		φ56 [φ2.20"]	φ67 [φ2.63"]
	Spindle nose	mm [inch]		A2-6	A2-8
	Spindle speeds	min <sup>-1</sup>		35~3500	30~3000
	Spindle motor	kW [hp]		11/15 [15/20]	18.5/22 [25/30]
	Slide stroke	X-axis	mm [inch]	220 [8.66"]	275 [10.8"]
		Z-axis	mm [inch]	295 [11.61"]	390 [15.4"]
	Feed motor	X-axis	kW [hp]	3 [4]	4 [5.4]
		Z-axis	kW [hp]	3 [4]	4 [5.4]
	Tooling			8-Pos.turret SM20	12-Pos.turret SM29
	CNC control			FANUC 180i-TB	FANUC 180i-TB
Robot Specifications	Robot Model		L292-H	L292-B1	
	Carrying capacity	kg [ lbs ]	5+5 [11+11]	10+10 [22+22]	
	Robot controller		MAX-SP1	MAX-SP1	
	Auxiliary Loader		Standard (2)	Standard (2)	
	Work Stocker		12Pallets	10Pallets	
Machine Size	Footprint	mm [inch]	3270×1890 [10'9" ×6'2"]	3270×2106 [11'9" ×6'11" ]	
	Height	mm [inch]	2290 [7'6"]	2419 [7'11" ]	
	Weight	kg [ lbs ]	7000 [15,400]lbs	8980 [19,800]lbs	

Specifications are subject to change without notice.

## Machine Dimensions

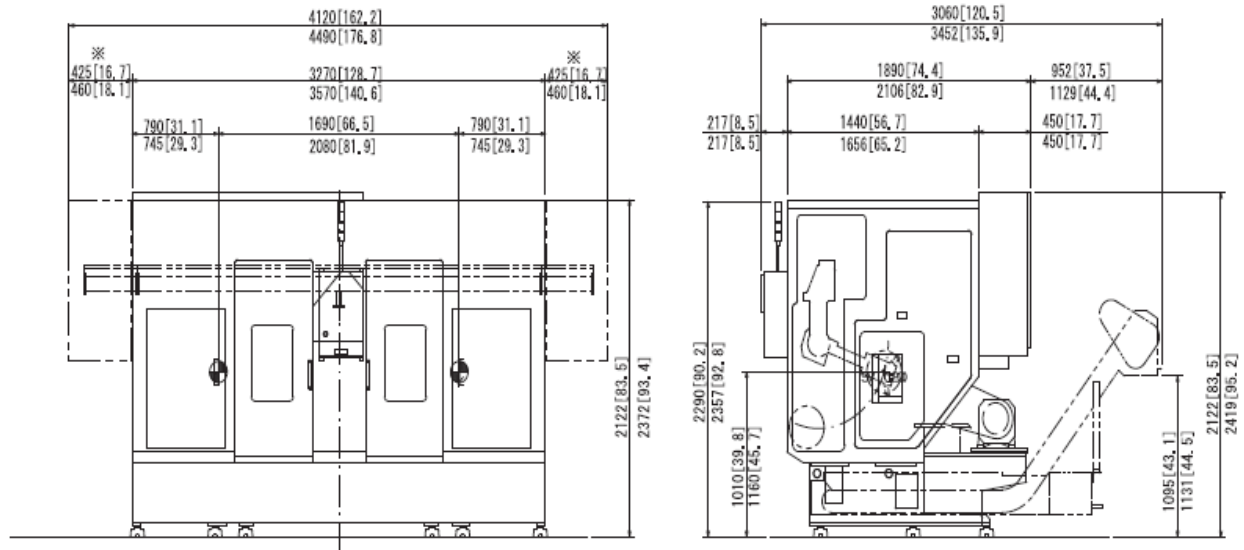

※ EXTEND TRAVEL BED

Dim upper-ANW3000  
lower-ANW4100

### List of repairs/new components

1. Spindle Motors rebuilt
2. New electric turrets
3. New lube blocks
4. Flush lube lines, replaced where needed
5. New Ballscrews and bearings for X and Z Axis for both sides
6. Left & Right Saddle rescraped and new fitted gibs
7. Wipers/scrapers
8. New trucks on aux loader
9. Completely cleaned and painted

Note: No chipconveyor included.

Contact Us: 423-887-5656; 865-388-6580 [info@precision-tec.com](mailto:info@precision-tec.com)

[www.Precision-Tec.com](http://www.Precision-Tec.com)